

Your Past, Present and Future

Chapter Meetings are generally held on the third Tuesday of the month and include networking hour, technical presentation, and dinner. Board meetings are regularly held on the first Tuesday of the month.

- 12/2025 Holiday Party
- 01/2026 Sound Transmission Demonstration**
- 02/2026 Liquid Applied Membranes
- 03/2026 Building Tour of Boy's Club
- 04/2026 Energy Code Modeling Tutorial
- 05/2026 Scavenger Hunt
- 06/2026 Summer Social Baseball Game
- 07/2026 Golf Tournament
- 08/2026 Planning Session
- 09/2026 Negotiation and Conflict Resolution

Inside this Issue:

Worcester Board Directory
President's Message
Recap: 2025 WCCSI Holiday Extravaganza
ADU Design Challenge Announced: Submissions
Being Accepted Now
February Program: Liquid Applied Membranes

Thank You to Our Sponsors:

Al Brousseau Flooring
Antonelli Construction
Arthur Cole Painting
Avidia Bank
Crawford Truck
Elite Construction & Design
Guaranty Glass
Hunter Douglas Architectural Window
Marsh McLennan Agency
MH Specs LLC
National Glass Works
Rockfon
The Garland Company

This Month's Chapter Event:

EVENT: Sound Transmission Demonstration

"Now Hear This!" No, literally - join WCCSI this month for live demonstrations of how different wall construction affects sound transmission. You'll walk away with a much better understanding of what the STC ratings you're specifying actually sound like.

Sponsored in part by Marino Ware metal framing systems.



Soundproof Wall Construction

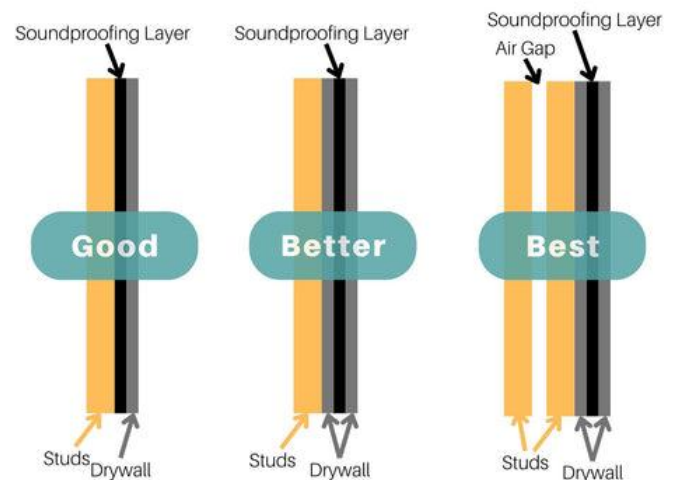

WHEN: Tuesday January 20, 2026
5:30 – Social Hour
6:00 – Program
7:00 – Dinner and Networking
WHERE: Peppercorn's Grille & Tavern
455 Park Avenue
Worcester, MA 01610
COST: \$25 (includes buffet)

Please RSVP to Terri Bracken at
neregcsi@gmail.com by January 16th.

Worcester CSI Board

President: Stephen VanDyke, CCS, CDT, NCARB
Nault Architects, Inc.
Worcester, MA 508.755.6134
steve@naultarchitects.com

Vice President: Peter Caruso, RA, CSI, AIA, LEED AP, NCARB
Lamoureux Pagano & Associates, Inc.
Worcester, MA 508.752.2831
pcarus@lpaa.com

Secretary: Robert Gutmann, CSI, CDT
Gorman Richardson Lewis Architects
Hopkinton, MA 508.544.2726
RGutmann@grlarchitects.com

Treasurer: Michael Lapomardo, Jr., CSI, CDT
Antonelli Construction Co., Inc.
Worcester, MA 508.753.7436
tevey@townisp.com

Chapter Director: Roger Hoyt, RA, BS, CSI, CDT, USGBC
Construction Monitoring Services, Inc.
Marlboro, MA
rhpb23@gmail.com

Chapter Director: Kendra Likely, BA, CSI, CDT
Landscape Forms, Inc.
Kalamazoo, MI 269-276-4596
KendraL@landscapeforms.com

Chapter Director: Harry Poirier, CSI
Sika Corporation
Canton, MA 508-838-8432
poirier.harry@us.sika.com

Chapter Director: Betsy Ellery, CSI, CCPR, CDT
JB Sash & Door
Enfield, CT 860-830-5750
BetsyE@JBSash.com

Region Director: Maria Smith, CSI
KCMGroup RI
Attleboro, MA 401-406-0058
mgsmith1349@gmail.com



From the President's Desk:

Steve VanDyke, CCS, CDT, NCARB



Welcome 2026!

Have you made any New Year's resolutions? Most seem centered around self-improvement, like dieting, quitting smoking or the trendy "dry January" where you quit drinking for a month. I think most folks would confess that these attempts, while well intended, have little lasting effects. The weight comes back, you sneak a smoke and, well, quitting anything for a month isn't really intended to make any appreciable change. This year, why not make a resolution to improve yourself professionally? You could:

- **Pursue a CSI Certification.** The Northeast Region is offering online preparation classes for the Construction Document Technologist (CDT) test, and you can find details at www.nercsi.com. Already have a CDT? How about a Certified Construction Specifier (CCS), Certified Construction Contract Administrator (CCCA) or a Certified Construction Product Representative (CCPR)? Enhance your resume by showing the world that you really do know what you are doing!
- **Attend a WCCSI monthly program.** We meet every third Tuesday of the month, offering a wide variety of topics, typically accredited by AIA for HSW learning units. The original alternative to the lunch-and-learn snooze-fest, our programs are engaging and usually involve hands-on demonstrations, crowd participation and frequent road trips to manufacturers and showrooms. You don't get a cocktail hour in the office conference room, so increase your knowledge while having fun doing it.

MHspecsLLC

Architectural Specifications
Building Materials Consulting
Worldwide from Florence, Massachusetts

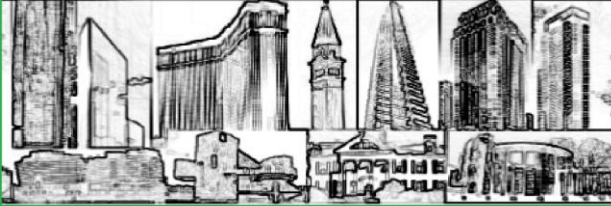

2176 Main Street – Lancaster, MA 01523
www.crawfordtruck.com 800-427-7404

AL BROUSSEAU FLOORING

905 Worcester Street
Southbridge, MA 01550
508-764-4453



Spencer + 508-885-6929

President's Message (cont) (by Steve VanDyke)

- **Check out the Northeast Region Conference.** Hosted in Buffalo, NY this year, you can check out a trade show, attend seminars, tour local architecture and participate in cocktail parties and an awards banquet. Most importantly, expand your network of trusted advisors making you more knowledgeable and thereby more valuable to your employer and clients.

These are easy resolutions which offer permanent changes for you. Credentials, knowledge and connections are not going to fade away after a month. They don't occupy months or years of your time and don't require you to give up anything that you love. In fact, they are actually fun. So make a resolution this year to become more engaged in Worcester County CSI and to make an investment in improving yourself professionally. I guarantee you won't regret it.

Recap: 2025 WCCSI Holiday Extravaganza (by Steve VanDyke)

An audaciously good time was had by all who attended the annual WCCSI Holiday Extravaganza on December 12 at J. Anthony's in Auburn. The evening began with holiday cocktails, an appetizer buffet with a half-dozen selections on it and socializing with friends while acclaimed local magician George Saterial circulated through the room performing table magic and leaving you scratching your head.

After settling in, George gave a comedy/magic performance for the room which left everyone laughing and wondering "how did he do that"? Especially when he used our own chapter president Steve VanDyke as his puppet to perform the tricks for him.

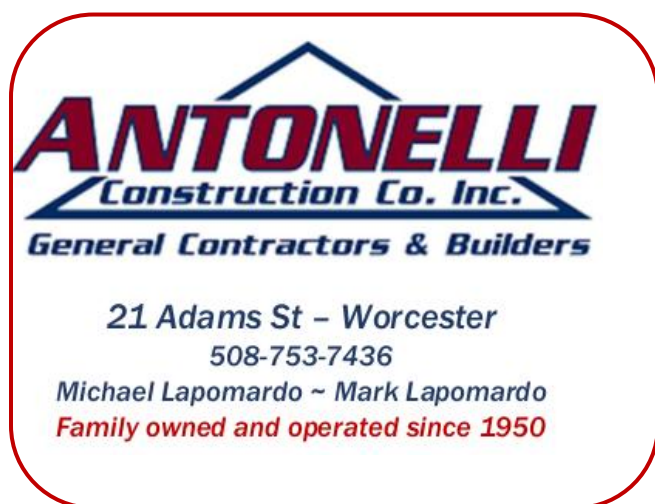

Recap: 2025 WCCSI Holiday Extravaganza (cont) (by Steve VanDyke)



After the show we feasted on a buffet including pasta, chicken and a steak carving station, before starting the highlight of the evening – the Audacious Yankee Swap. Mark Lapomardo, the perennial MC for the swap lent his sober version of sarcasm while presenting the gifts to the group for the keep-or-swap decision.



The hot prize this year was a kitschy cookie jar from Savers hiding a mason jar of moonshine inside it brought by Maria and Tom Smith, while the goofiest gag in my opinion was a set of 4 harmonicas and a deck of Christmas carol cards used to play “name that tune” which ended up in a tear-jerking serenade of Jingle Bells by Marty Helly and Steve VanDyke.

Too bad it wasn’t “Christmas Island”... We miss you Ted!



INSURANCE

100 Front Street – Suite 800

Worcester, MA 01608

T: 888-850-9400 F: 508-852-8600



ELITE CONSTRUCTION & DESIGN

FITCHBURG

978-597-5071

National Glass Works

Worcester – Westboro



508-735-7209

508-366-7300

www.nationalglassworks.com

Arthur Cole Painting COMMERCIAL PAINTERS



39 Mason St

Worcester

508-799-9019

ADU Design Challenge Announced: Submissions Being Accepted Now (by Terri Bracken)



Submissions are officially open for the Massachusetts ADU Design Challenge **announced** by Governor Healy on December 15, 2025. The challenge is part of a larger initiative designed to address the shortage of affordable housing in the Commonwealth.

The ADU Design Challenge invites Massachusetts architects, builders, designers, contractors, and design-build teams practicing in the State of Massachusetts to help solve that problem by creating high-quality, ready-to-use ADU plans. This initiative is about reducing the cost and complexity of building small homes — and showing how good design can make housing more accessible, sustainable, and achievable across the Commonwealth.

This challenge is supported by [AIA Massachusetts](#), [MHP \(Massachusetts Housing Partnership\)](#), [Eastern Bank Foundation](#) and [The Boston Foundation](#), with roughly \$75,000 in sponsor commitments for prizes and outreach — no state dollars are being used for prizes.

Submissions are open through February 27, 2026. Visit [here](#) for complete information.

Want more information? **The first webinar on this challenge is this Friday at 12 PM.** Register now to attend.



LIQUID APPLIED MEMBRANES The Low-Slope Anti-Aging Cream...

WHEN: Tuesday February 24, 2025

5:30 – Social Hour

6:00 – Program

7:30 – Dinner and Networking

WHERE: Greenwood Industries
640 Lincoln St.
Worcester, MA 01605

COST: Members and Non-members \$15
Includes food and drinks



Ben Franklin once said, “*An ounce of prevention is worth a pound of cure*” and never have those words rung truer than when it comes to your low-slope roof. They’re not just expensive to tear-off and replace but not maintaining them usually results in even more expense from repairing damages to the interior finishes the leaks cause. What if there was a way to restore the performance of an aging roof, and get a warranty backed by an industry leading roofing manufacturer? Well, there is, and its called Liquid Applied Membrane (LAM), but this emerging technology can be a slippery slope for the novice. With chemistries including silicone, polyurethane, acrylics and a handful of others, how do you know which to specify? And with a list of acceptable substrate conditions, how do you know if your roof is even a candidate for coating? And if it is a candidate, how do you detail this system? Overwhelmed? Don’t worry – WCCSI is going to show you the ropes, literally.

Liquid applied membranes are high-performance roof systems and should not be confused with simple roof coatings. The effectiveness and versatility of liquid applied membranes often make them a viable solution for the most challenging roofing and waterproofing projects. This seminar will focus on the use of such Liquid Applied Membrane (LAM) systems as an alternative to conventional roof membrane systems. The use of these systems in roofing, waterproofing, and historic preservation applications will be discussed. Hosted by Harry Poirier and Mike Dadekian of Sika Sarnafil, you’ll come away with a solid understanding of the proper use of these systems.

The savvy folks at Greenwood Industries, one of Worcester’s largest roofing contractors have agreed to open up their shop to perform live demonstrations showing how to do it right, following a PowerPoint presentation from the folks at Sika Sarnafil, world leaders in roofing technology. Whether you’re a designer who details/specifies these systems, a General Contractor responsible for a system being installed by a sub, or even a product rep with a system that integrates into the roofing system, we can always benefit by actually seeing it done.

After attending this program attendees will:

1. Identify different types of roof coatings, and the pros and cons of each.
2. Tell whether a roof is a good candidate for coating or too far gone.
3. Understand how to properly specify and detail LAM systems.
4. Confidently inspect and evaluate work in progress and completed work in the field.

So why sit in your office for that boxed lunch-and-learn from Panera when you can get out, have drinks, network with like-minded professionals and learn the ins and outs of liquid applied membranes while munching on pizza with drinks? This program is approved by the AIA for 1 HSW continuing education unit. Interested? RSVP to Terri Bracken at neregcsi@gmail.com and get yourself on the list!